

FM-1000 & FMX

1) Go to WRENCH / SCREWDRIVER icon.



2) Select GPS Receiver.



3)Select DIAGNOSTICS.

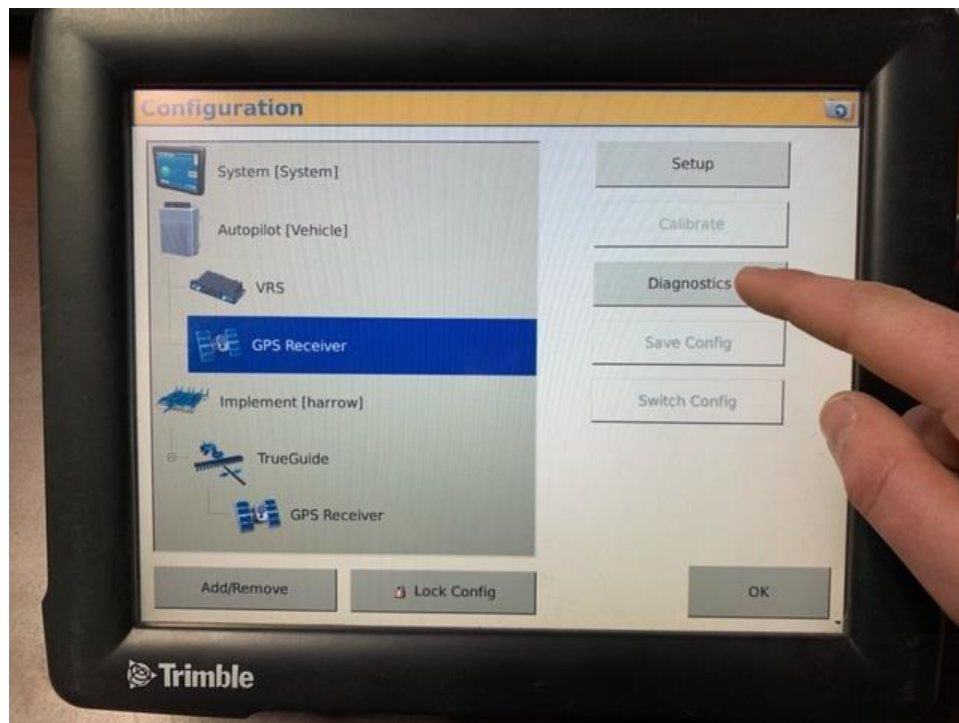

4)Select AgRemote.

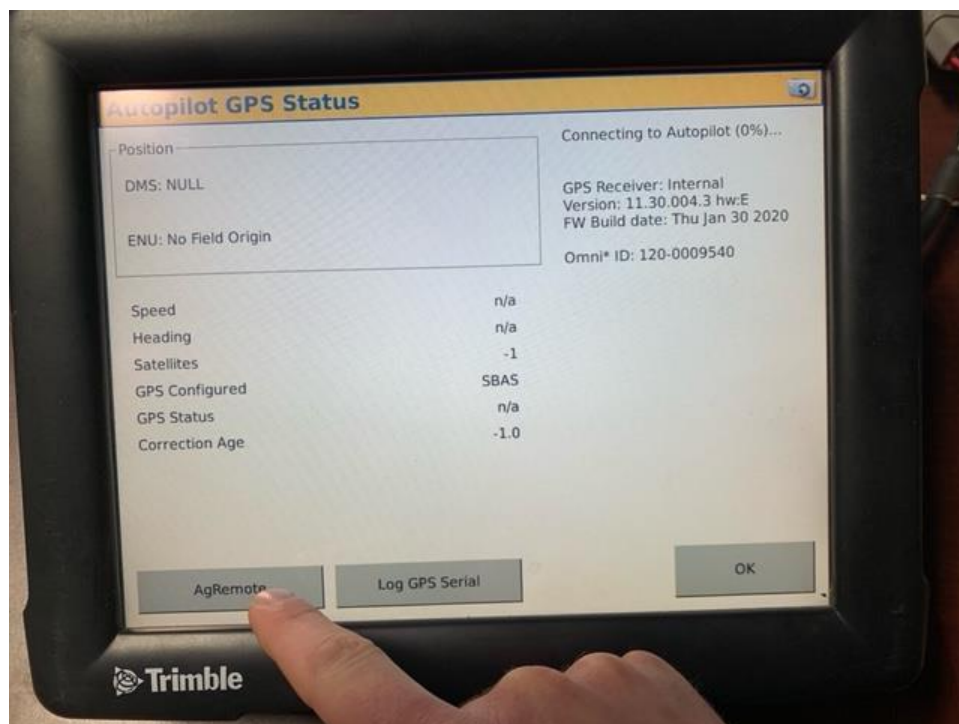

5) Press the RIGHT ARROW.

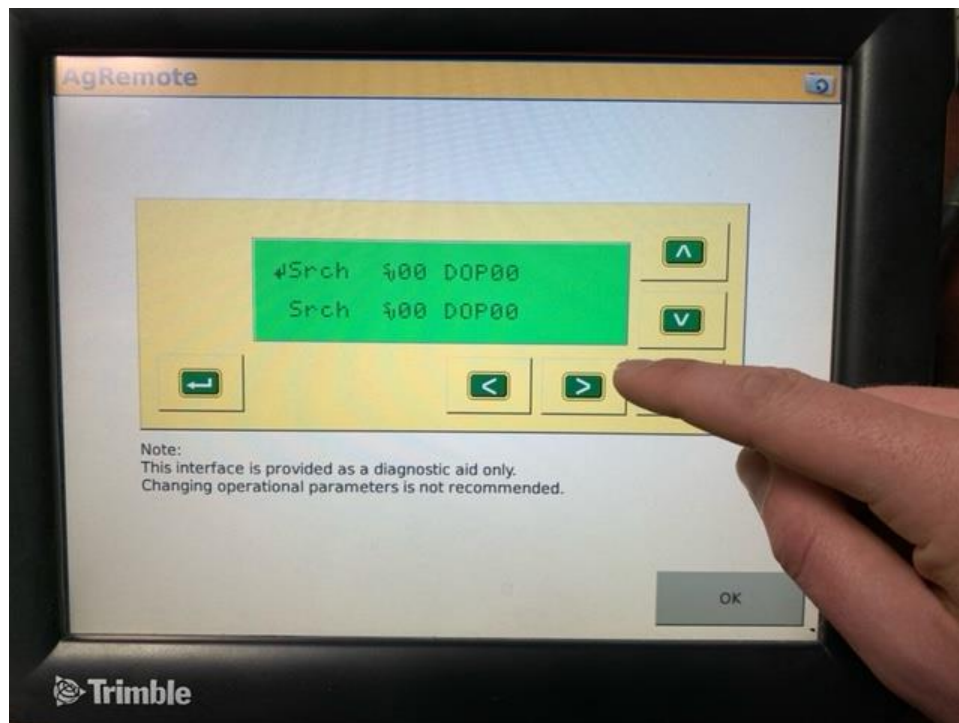

6) Press the RIGHT ARROW.

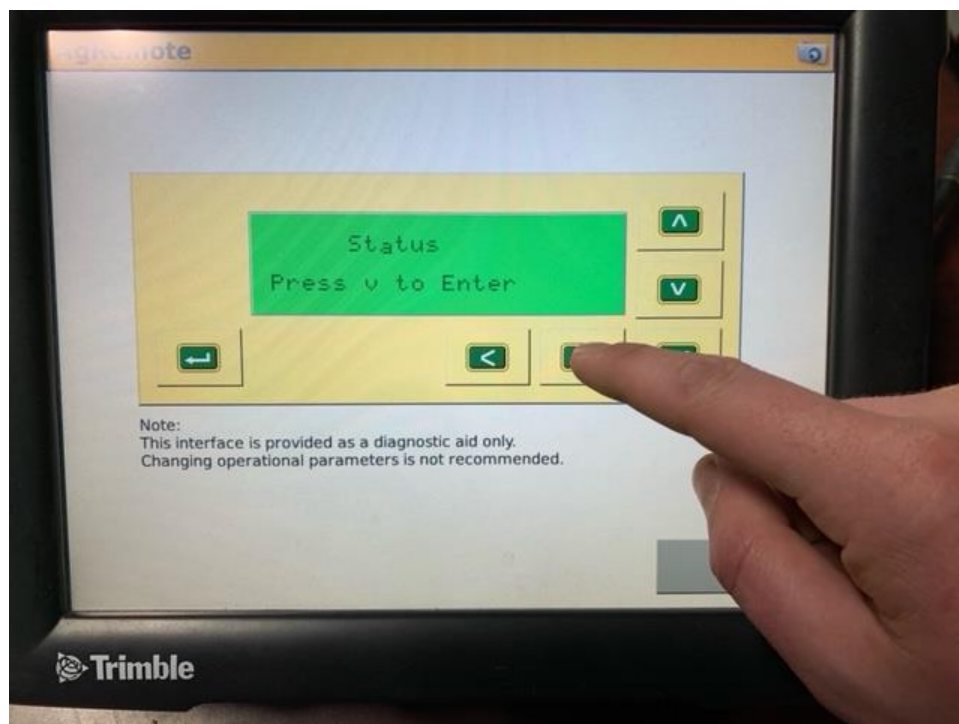

7) Press the DOWN ARROW.

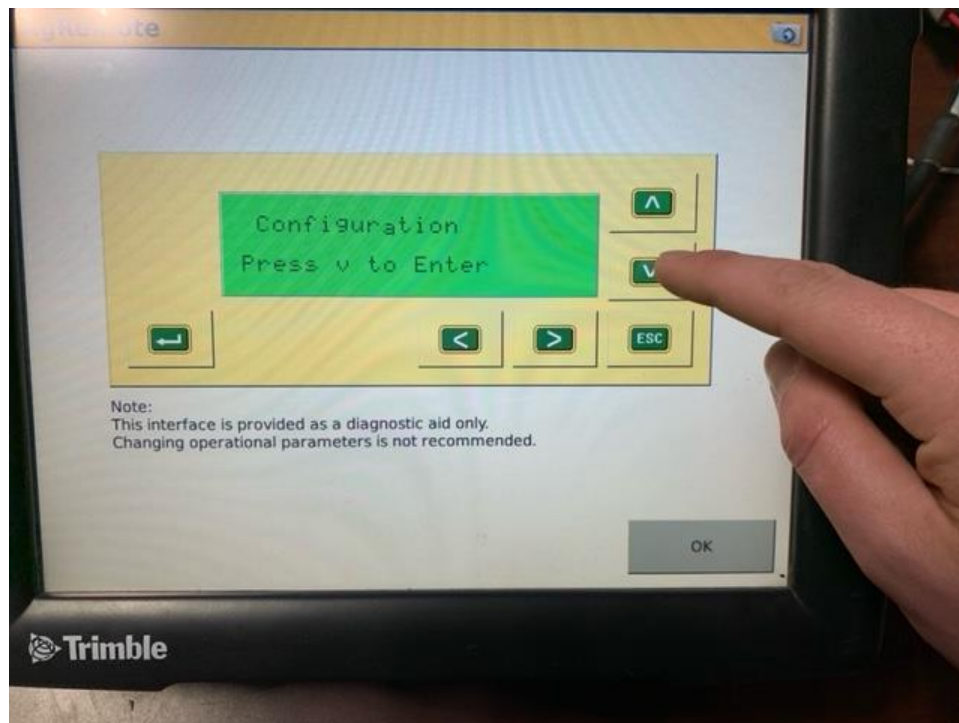

8) Press the RIGHT ARROW.

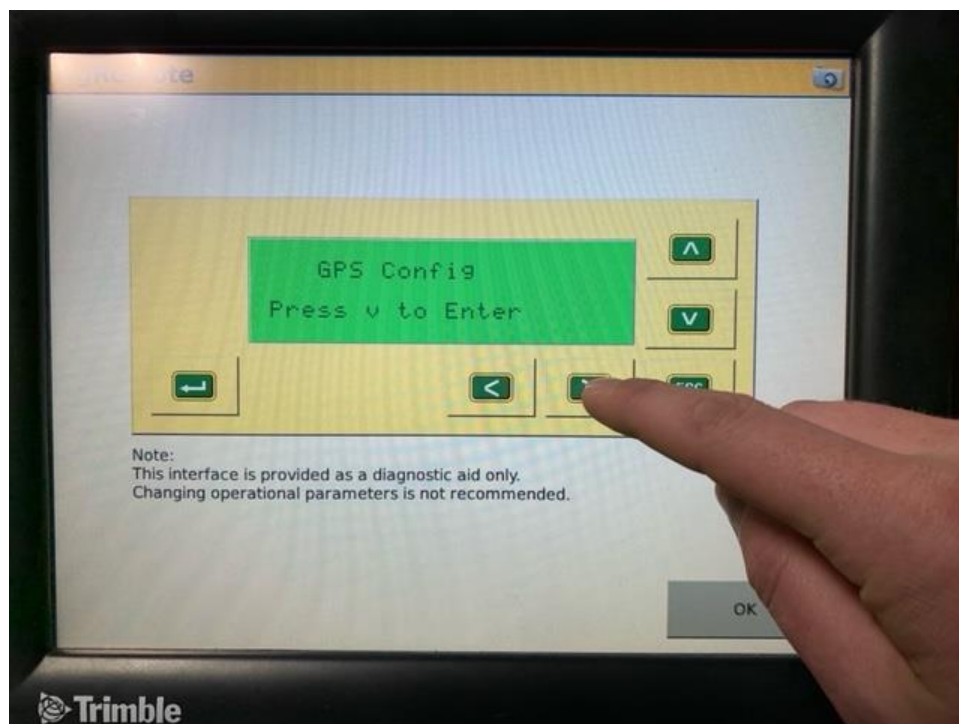

9) Press the DOWN ARROW.

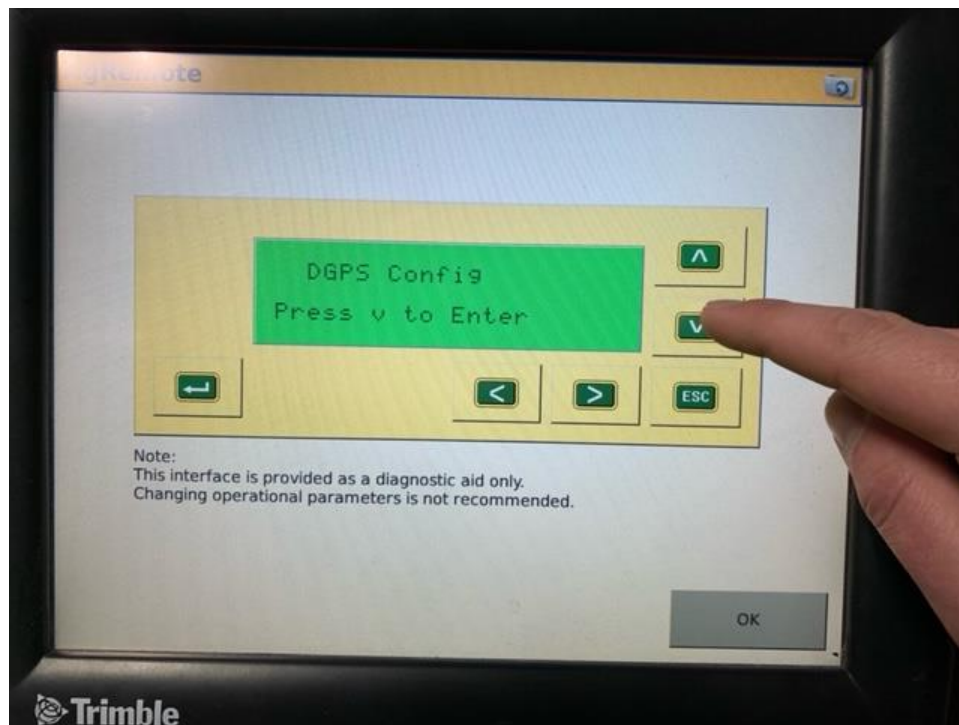

10) Press the DOWN ARROW.

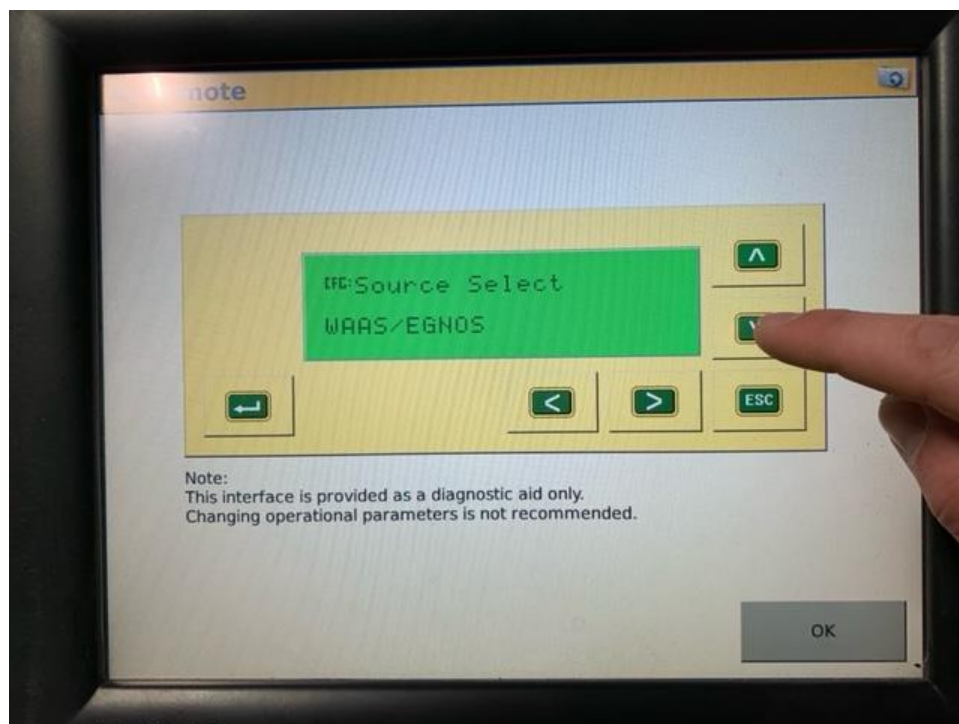

11) Press the DOWN ARROW.

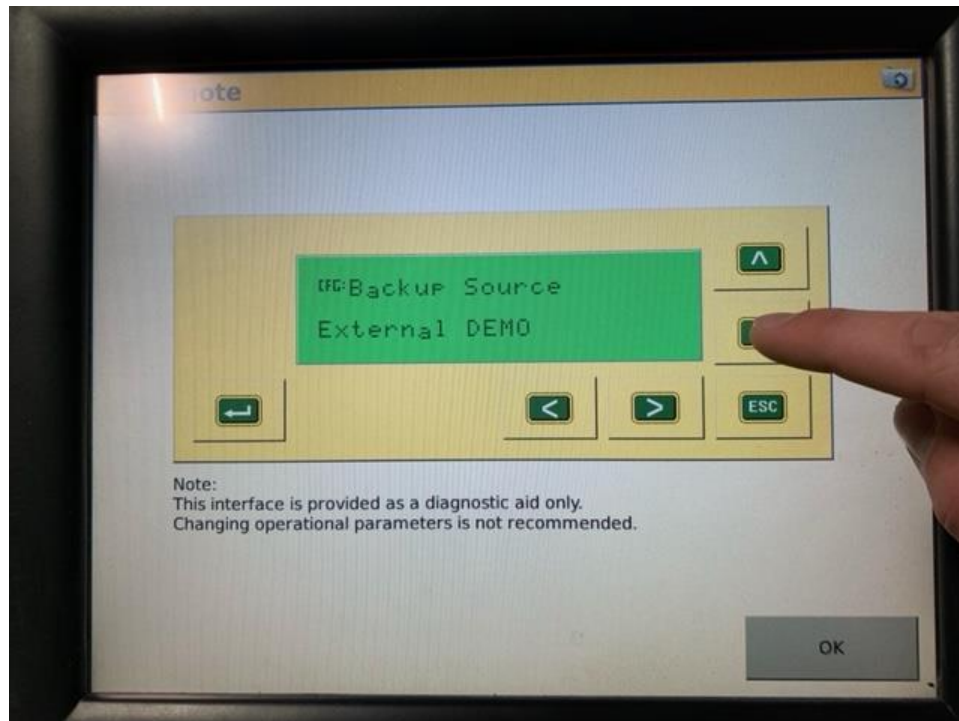

12) Press the DOWN ARROW.

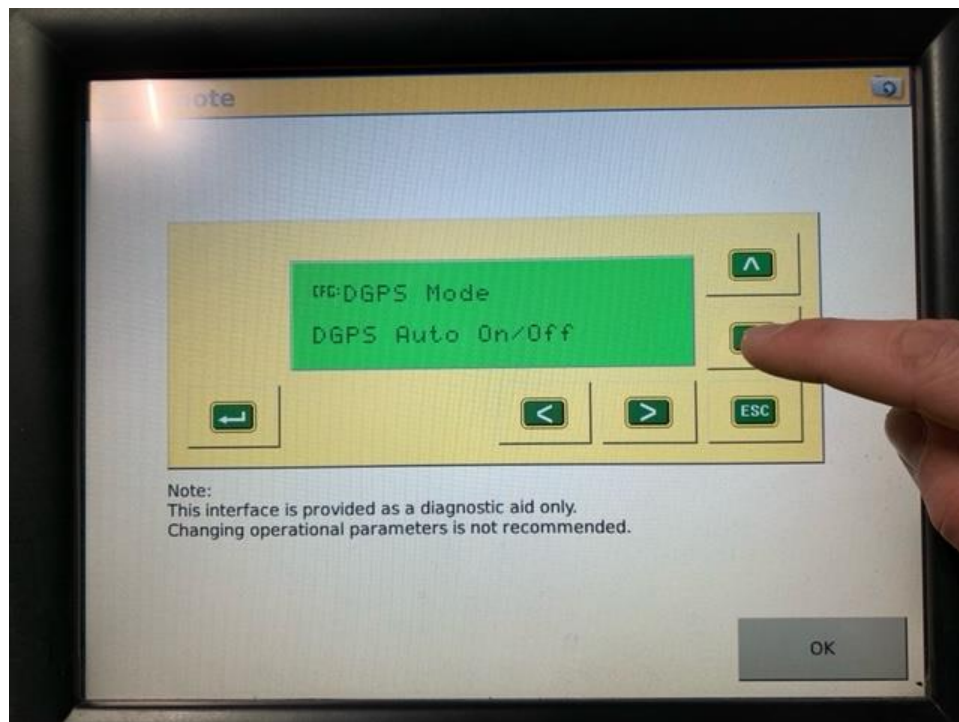

13) Press the DOWN ARROW.

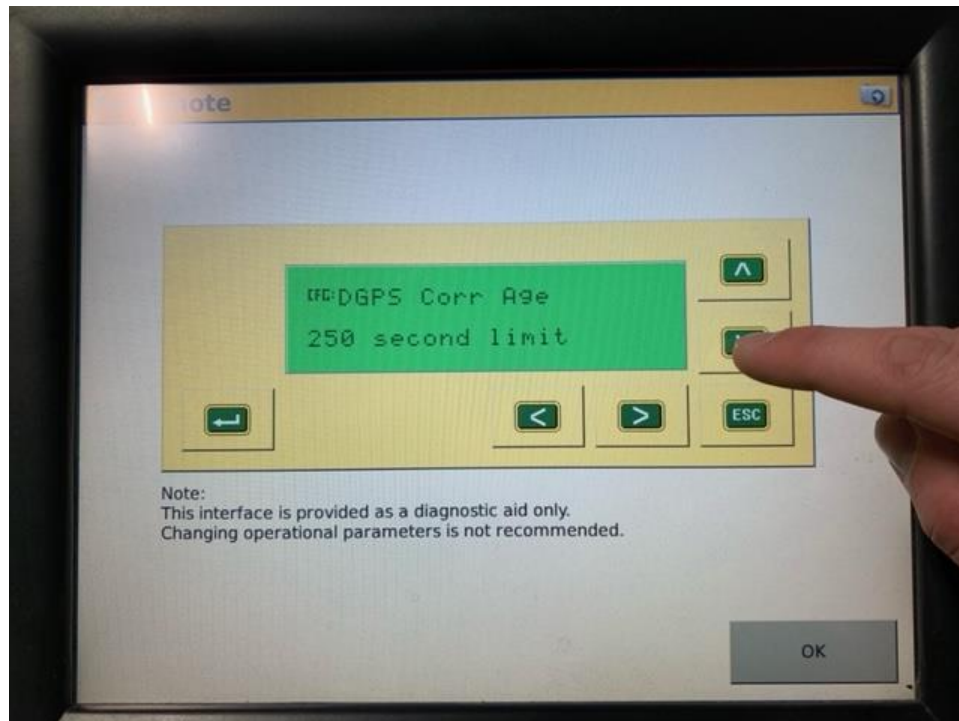

14) Press the DOWN ARROW.

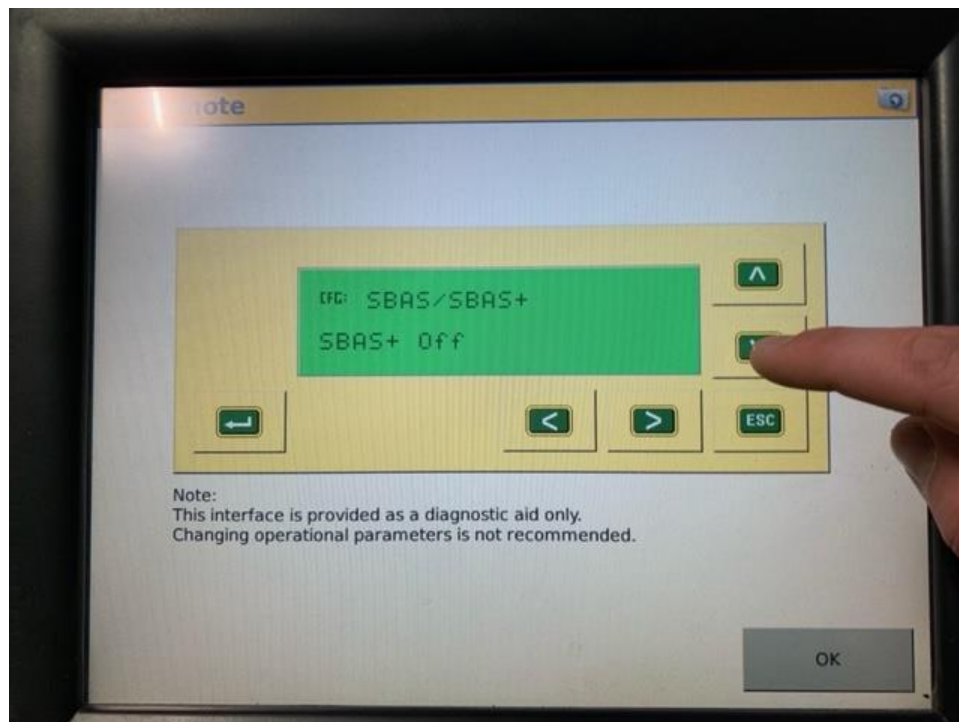

15) Press the RIGHT ARROW.

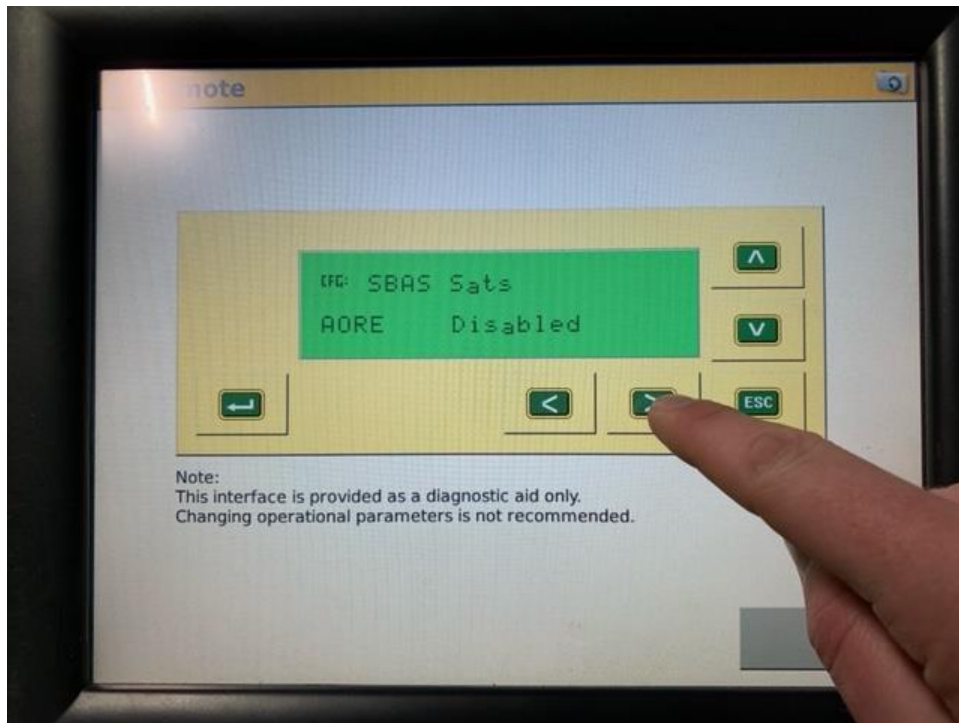

16) Press the DOWN ARROW.

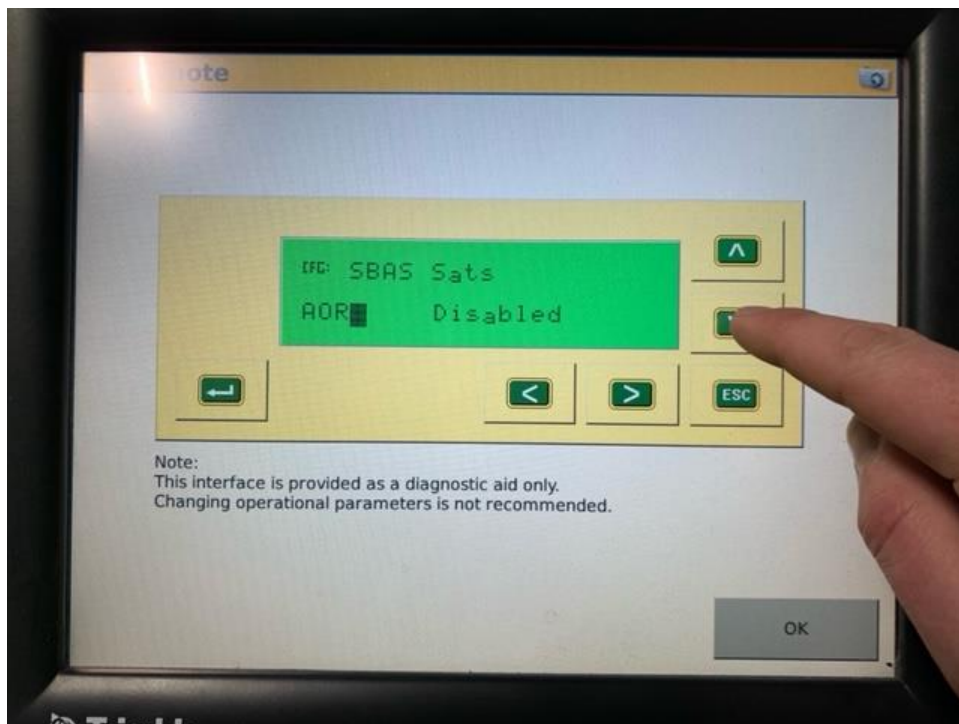

17) Press the DOWN ARROW.

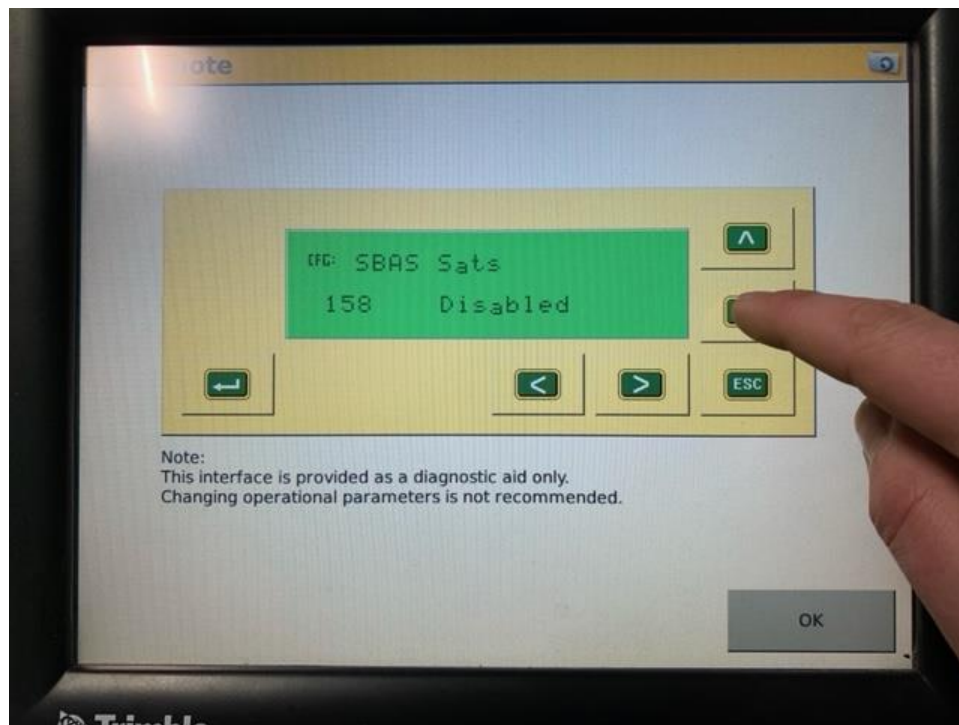

18) Press the DOWN ARROW.

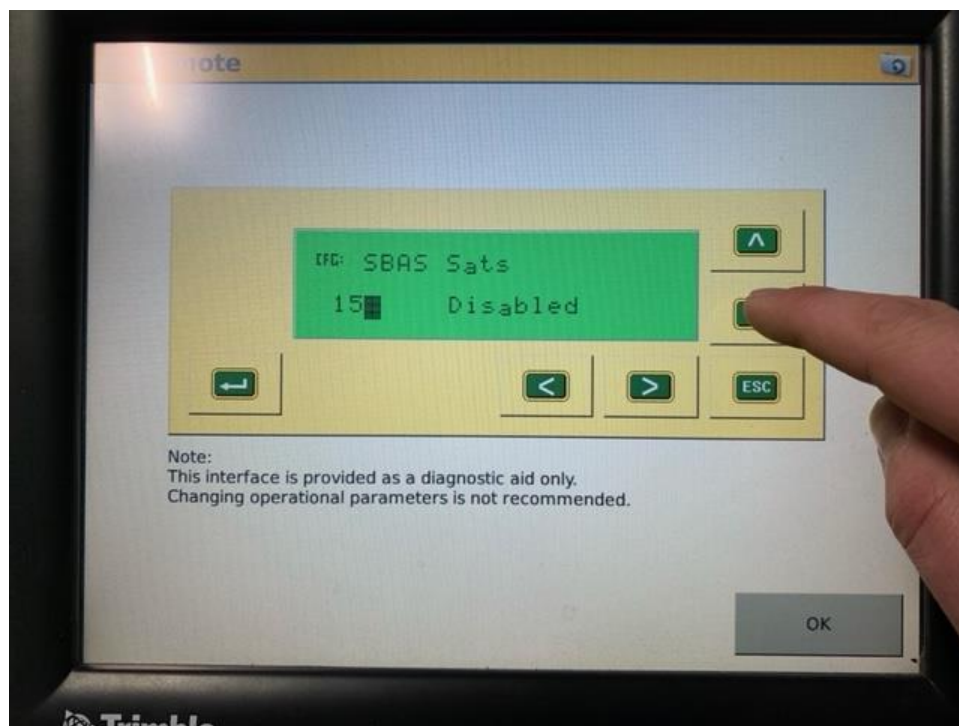

19) Press the DOWN ARROW.

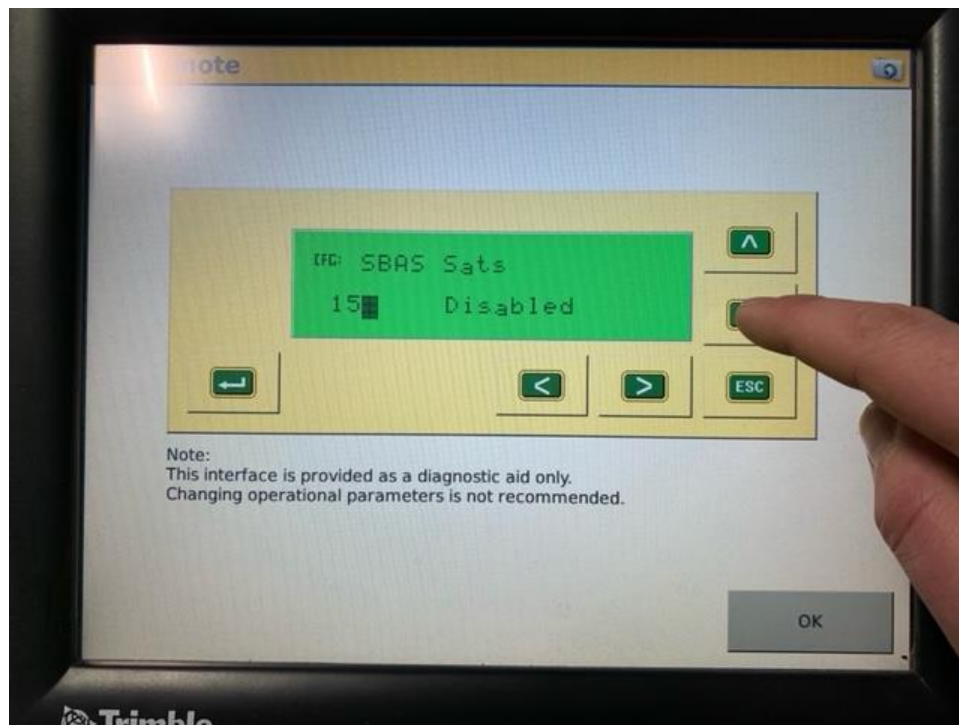

20) When "138" is displayed, press the RIGHT ARROW.

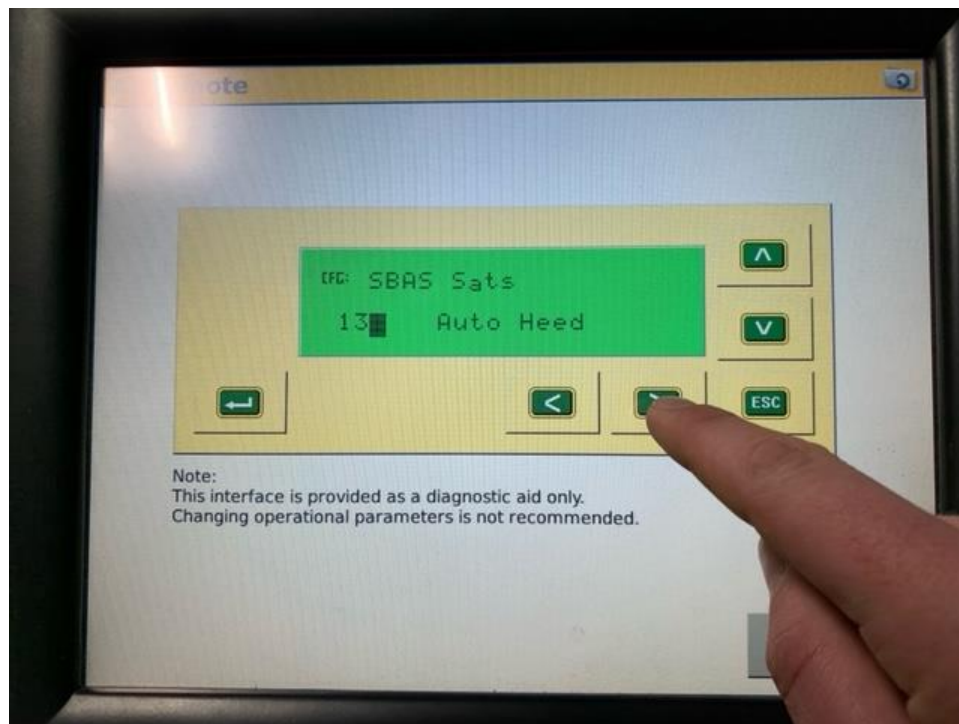

21) Press the DOWN ARROW to switch it to “Disabled”.



22) Press the RIGHT ARROW and then the DOWN ARROW

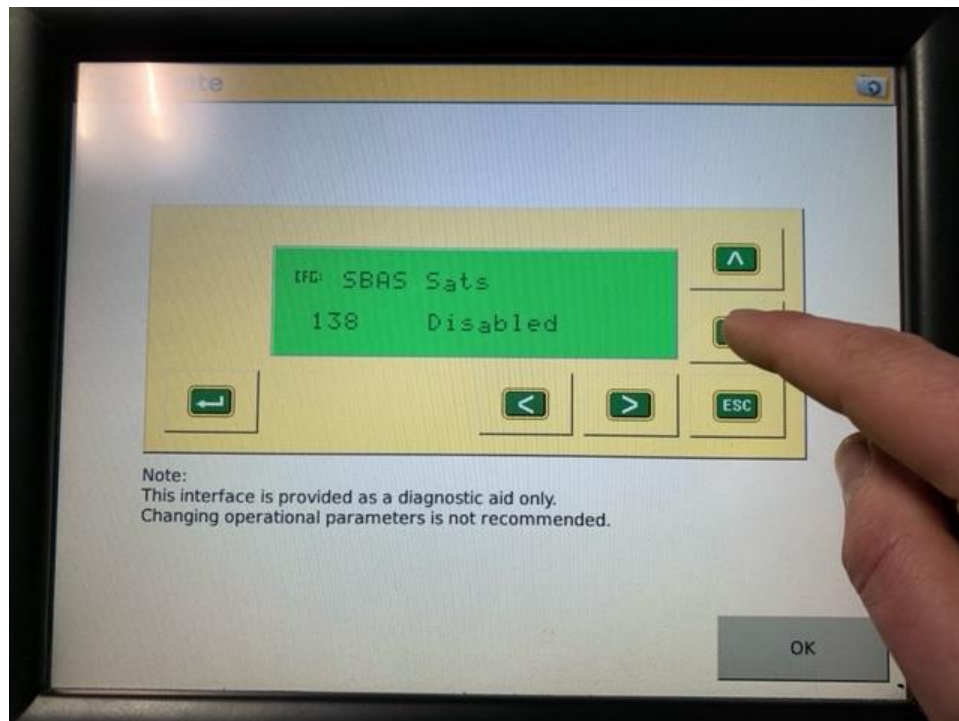

23)When “135” is displayed, press the RIGHT ARROW.

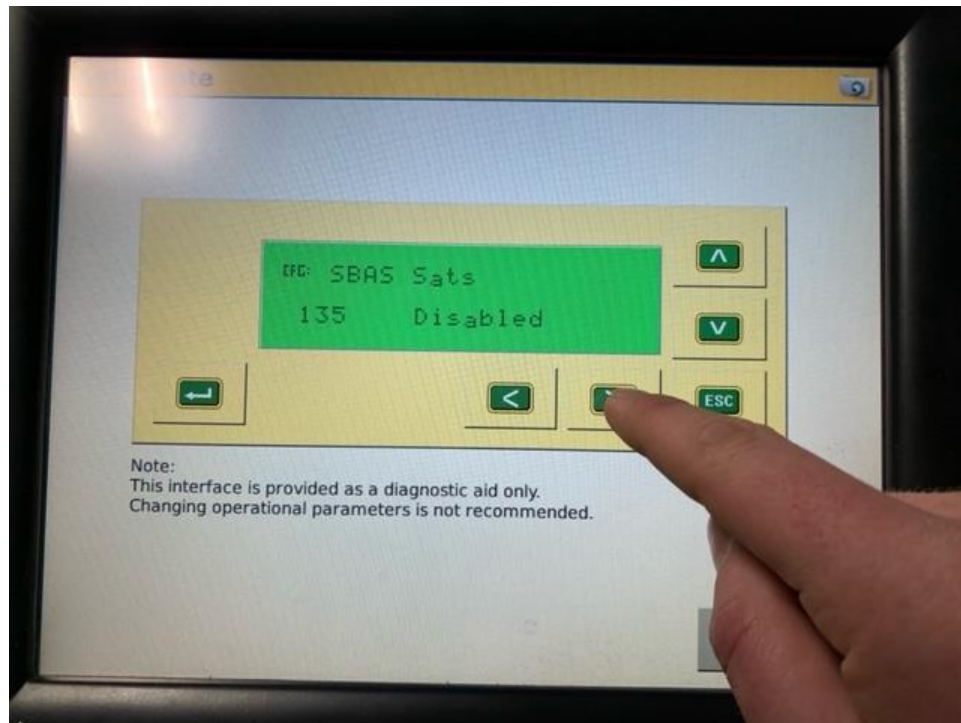

24)Press the DOWN ARROW until “Heed Health” is displayed.

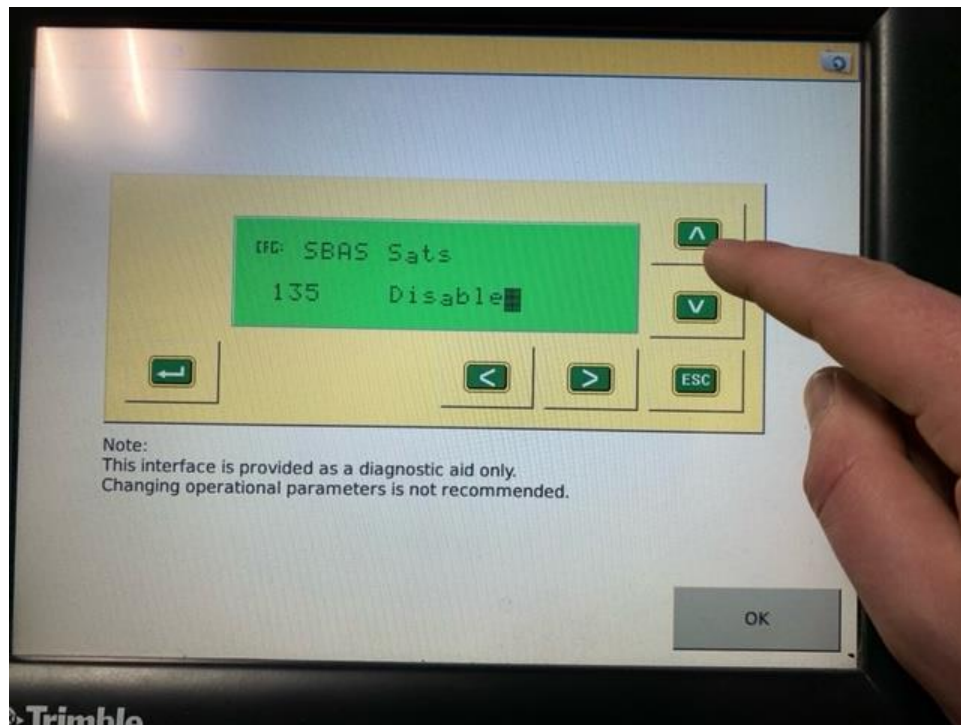

25) Press the RIGHT ARROW, then press OK.

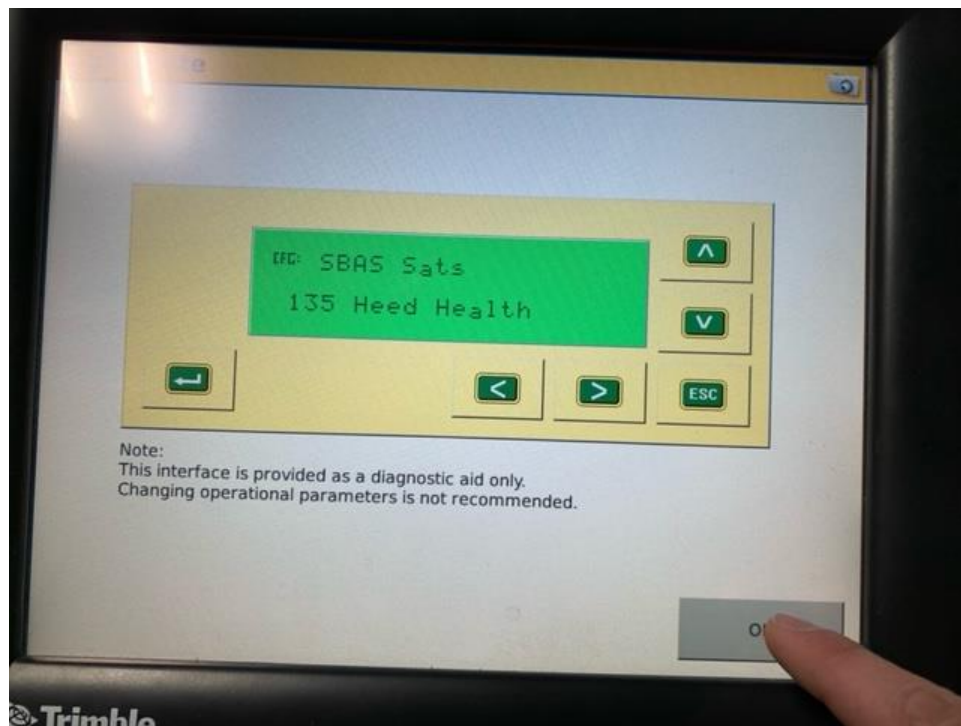

**Thank you for supporting Vanee Farm Centre.
If you require any assistance with these
changes, please call your Precision Specialist.**

Nolan Pitt **403-852-0064**

James Siebert **403-308-4012**

John Reimer **403-308-7327**